



REF: RD-55040
New Build · Villa · Aspe



3 BEDROOMS



3 BATHROOMS



188M²



13.172M²



YES



B



Edificacio	Modelo	Area
Edificacio	Trinera	6,01 m ²
terreno		
Edificacio auxiliar		6,01 m ²
Vivienda	Donostia 3	12,89 m ²
Vivienda	Donostia 2	13,89 m ²
Vivienda	Donostia 1	13,23 m ²
Vivienda	Yubero	7,25 m ²
Vivienda	Itza 1	8,28 m ²
Vivienda	Itza 2	5,51 m ²
Vivienda	Solbe	2,58 m ²
Vivienda	Arae	2,28 m ²
Vivienda	Pealba	6,19 m ²
Vivienda	Araera	6,96 m ²
Vivienda	Itxubakar	4,27 m ²
Vivienda	Itzae	11,88 m ²
Vivienda	Solbe-Gondra	18,84 m ²
Vivienda	Teresa colabeta	21,58 m ²
Vivienda	Teresa colabeta	2,76 m ²
Vivienda	Teresa colabeta	6,48 m ²
Vivienda		13,29 m ²
TOTAL SUP. CONSTRUIDA		119,90 m ²

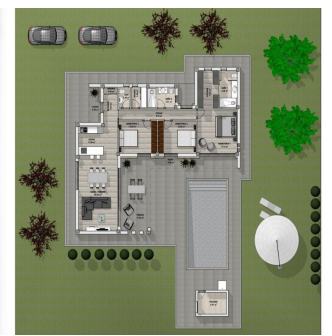

Superficie Construida	
Modelo	Area
Vivienda	14,13 m ²
Arae Colabeta	1,84 m ²
Teresa Colabeta	6,99 m ²
Pealba	13,23 m ²
Itxubakar	6,17 m ²
TOTAL SUP. CONSTRUIDA	119,26 m ²

Newly built villas located in the municipality of Aspe. Newly built villas with several models to choose from, with 2, 3 or 4 bedrooms, on one or two floors and built with slabs or with a structure: depending on the model and the plot chosen, the exact price will be calculated. All the villas are built on rustic plots of over 10,000 m², of which around 2,500 m² will be fenced off. The villas have an open-plan kitchen with living room, built-in wardrobes, private swimming pool, porch, storage room and outdoor parking space. There are several plots to choose from. The price is based on a plot priced at €75 000 (if another plot is chosen, the difference will be paid or credited according to the price of the plot). Self-build project, delivery in approximately 12 months from the granting of the licence. If you are looking for a quiet environment, close to typical Spanish villages away from tourist crowds, surrounded by mountains, with a very ...

key features

- Bedrooms: 3
- Bathrooms: 3
- Built: 188m²
- Plot: 13.172m²
- Energy Rating: B

Features

- Air Conditioning: Pre-Installed
- Beach: 25000 Meters
- Double Bedrooms: 3
- Garden
- Gated
- Location: Mountain
- Near Schools
- Number of Parking Spaces: 1
- Parking - Space
- Private Pool
- Storage / Trastero
- Terrace: 36 Msq.
- Useable Build Space: 159 Msq.