

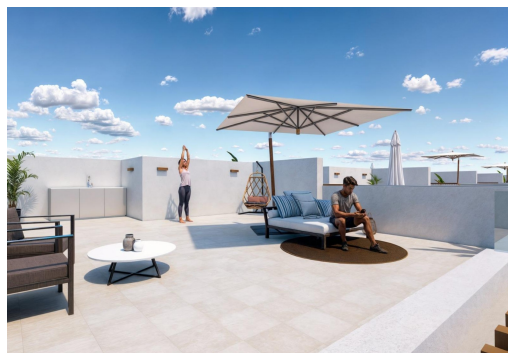

REF: RD-59325

New Build · Villa · Torre Pacheco



2 SCHLAFZIMMER



2 BADEZIMMER



73M²



162M²



JA



B



Hauptmerkmale

- Schlafzimmer: 2
- Gebaute Fläche: 73m²
- Energiebewertung: B
- Badezimmer: 2
- Grundstück: 162m²

Charakteristik

- Air Conditioning: Pre-Installed
- Double Bedrooms: 2
- Gated
- Near Commercial Center
- Number of Parking Spaces: 1
- Private Pool
- Terrace: 87 Msq.
- Beach: 10000 Meters
- Garden
- Location: Rural
- Near Schools
- Parking - Space
- Solarium: Yes
- Useable Build Space: 65 Msq.