

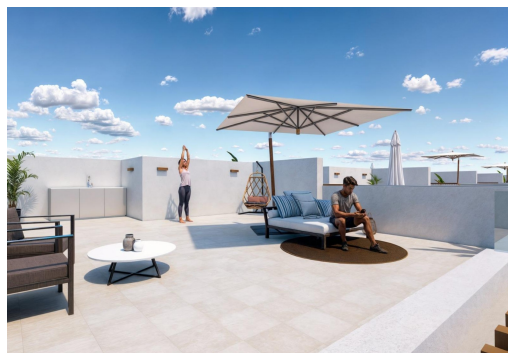

REF: RD-76102

New Build · Villa · Torre Pacheco



3 SCHLAFZIMMER



2 BADEZIMMER



90M²



198M²



JA



B



Hauptmerkmale

- Schlafzimmer: 3
- Gebaute Fläche: 90m²
- Energiebewertung: B
- Badezimmer: 2
- Grundstück: 198m²

Charakteristik

- Air Conditioning: Pre-Installed
- Double Bedrooms: 3
- Gated
- Near Commercial Center
- Number of Parking Spaces: 1
- Private Pool
- Terrace: 103 Msq.
- Beach: 10000 Meters
- Garden
- Location: Rural
- Near Schools
- Parking - Space
- Solarium: Yes
- Useable Build Space: 80 Msq.