



REF: RD-95918

Novostavba · Apartment · Benijófar



3 LOŽNICE



2 KOUPELNY



115M<sup>2</sup>



0M<sup>2</sup>



ANO



B



VIVIENDA BA	
SUPERFICIE ÚTIL / FLOOR AREA	
1. Sala (open-plan kitchen / Living dining kitchen)	42,77 m <sup>2</sup>
2. Dormitorio (Bed)	1,05 m <sup>2</sup>
3. Dormitorio 2 / Bedroom 1	10,00 m <sup>2</sup>
4. Dormitorio 3 / Bedroom 2	10,00 m <sup>2</sup>
5. Dormitorio 4 / Bedroom 3	8,26 m <sup>2</sup>
6. Baño 1 / Bathroom 1	5,20 m <sup>2</sup>
7. Baño 2 / Bathroom 2	2,16 m <sup>2</sup>
8. Lavadero / Laundry	3,10 m <sup>2</sup>
9. Terraza 1 / Terrace 1	2,74 m <sup>2</sup>
10. Terraza 2 / Terrace 2	20,22 m <sup>2</sup>
<b>TOTAL ÚTIL / TOTAL FLOOR AREA</b>	<b>94,46 m<sup>2</sup></b>
SUPERFICIE CONSTRUIDA / BUILT AREA	
Sala, comedor, cocina / Living, dining, kitchen	11,15 m <sup>2</sup>
Baños / Bathrooms	2,16 m <sup>2</sup>
Terraza cubierta 1 / Covered Terrace 1	20,22 m <sup>2</sup>
<b>TOTAL ÚTIL CONSTRUIDA / TOTAL BUILT AREA</b>	<b>40,53 m<sup>2</sup></b>

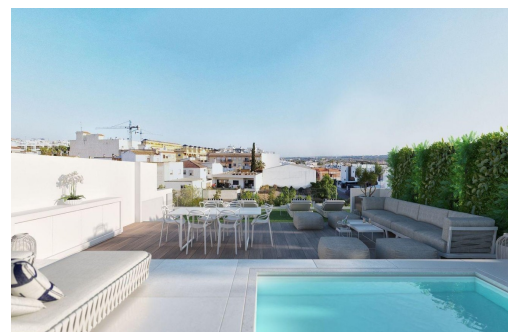

## Klíčové vlastnosti

- Ložnice: 3
- Postaveno: 115m<sup>2</sup>

- Koupelny: 2
- Energetické hodnocení: B

## Vlastnosti

- Air Conditioning: Pre-Installed
- Communal Pool
- Elevator/Lift
- Location: Rural, Urbanisation
- Near Commercial Center
- Number of Parking Spaces: 1
- Storage / Trastero
- Useable Build Space: 95 Msq.

- Beach: 8000 Meters
- Double Bedrooms: 3
- Gated
- Near Bus Route
- Near Schools
- Parking - Space
- Terrace: 25 Msq.