

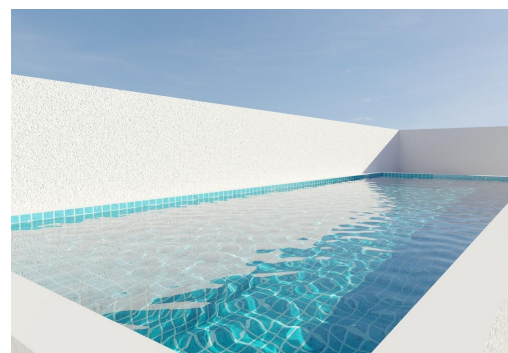

REF: RD-68335

New Build · Penthouse · Torrevieja

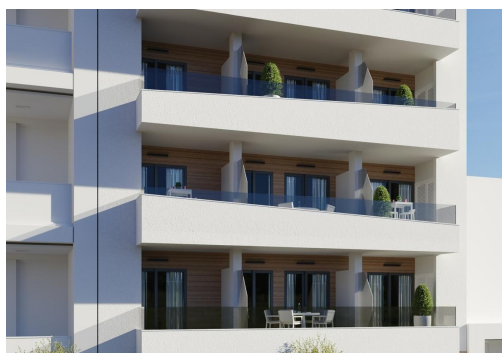

1 BEDROOMS



1 BATHROOMS



74M<sup>2</sup>



0M<sup>2</sup>



YES



B

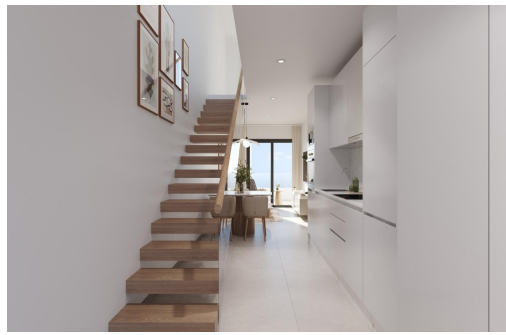

Newly built apartments in Torrevieja Just 600 metres from Playa del Cura beach Prime location in the heart of Torrevieja Discover these brand new apartments and penthouses in one of the most sought-after areas of Torrevieja, just 600 metres from Playa del Cura beach and 300 metres from the seafront promenade. Located in the city centre, this lively neighbourhood offers all essential amenities within walking distance, including supermarkets, shops, restaurants, cafés and public transport. Torrevieja is a well-known coastal town on the Costa Blanca, famous for its mild Mediterranean climate, lively atmosphere and year-round seaside lifestyle. Modern apartments with spacious layouts This exclusive new development consists of only 12 one- and three-bedroom apartments and penthouses, designed for comfort, functionality and contemporary style. The apartments on the middle floors feature spacious terraces, while the penthouses...

## key features

- Bedrooms: 1
- Bathrooms: 1
- Built: 74m<sup>2</sup>
- Energy Rating: B

## Features

- Air Conditioning: Pre-Installed
- Beach: 600 Meters
- Communal Pool
- Double Bedrooms: 1
- Elevator/Lift
- Location: Coastal
- Near Bus Route
- Near Commercial Center
- Near Schools
- Parking - Space
- Solarium: Yes
- Terrace: 29 Msq.
- Useable Build Space: 66 Msq.