

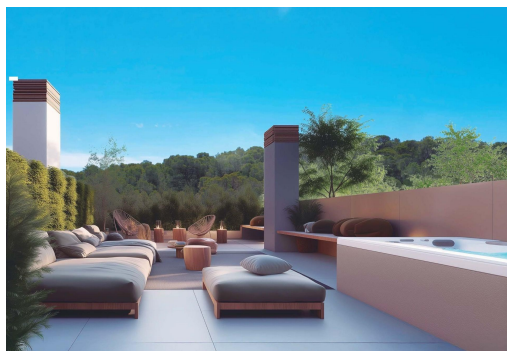

REF: SP-18118

Novostavba · Penthouse · La Nucia



  
2 LOŽNICE

  
2 KOUPELNY

  
87M<sup>2</sup>

  
0M<sup>2</sup>

  
ANO

  
B



## Klíčové vlastnosti

- Ložnice: 2
- Postaveno: 87m<sup>2</sup>
- Koupelny: 2
- Energetické hodnocení: B

## Vlastnosti

- Beach: 7000 Meters
- Double Bedrooms: 2
- Gated
- Location: Coastal, Urbanisation
- Near Commercial Center
- Number of Parking Spaces: 1
- Solarium: Yes
- Terrace: 80 Msq.
- Communal Pool
- Elevator/Lift
- Gym
- Near Bus Route
- Near Schools
- Parking - Space
- Storage / Trastero
- Useable Build Space: 62 Msq.